



SURVEYOR'S OFFICE

Hamilton County

Kenton C. Ward, Surveyor

Phone (317) 776-8495

Fax (317) 776-9628

Suite 188

One Hamilton County Square

Noblesville, Indiana 46060-2230

October 25, 2004

TO: Hamilton County Drainage Board

RE: Bridgewater Drain, Marina Village Arm.

Attached is a petition filed by The Marina Limited Partnership along with a non-enforcement request, plans, calculations, quantity summary and assessment roll for the Marina Village Arm, Bridgewater Drain to be located in Fall Creek Township. I have reviewed the submittals and petition and have found each to be in proper form.

I have made a personal inspection of the land described in the petition. Upon doing so, I believe that the drain is practicable, will improve the public health, benefit a public highway, and be of public utility and that the costs, damages and expenses of the proposed drain will probably be less than the benefits accruing to the owners of land likely to be benefited. The drain will consist of the following:

6" SSD	2,292 feet	15" RCP	138 feet
12" RCP	339 feet	18" RCP	112 feet

The total length of the drain will be 2,881 feet.

The subsurface drains (SSD) to be part of the regulated drain are those located under the curbs for the private street. Only the main SSD lines which are located within the easement right of way for Marina Village Drive are to be maintained as regulated drain. Laterals for individual lots will not be considered part of the regulated drain.

I have reviewed the plans and believe the drain will benefit each lot equally. Therefore, I recommend each lot be assessed equally. I also believe that no damages will result to landowners by the construction of this drain. I recommend a maintenance assessment of \$10.00 per acre for common areas (and platted lots), \$65.00 for platted lots, \$10.00 per acre for roadways, with a \$65.00 minimum. With this assessment the total annual assessment for this drain/this section will be \$1,170.00

The petitioner has submitted surety for the proposed drain at this time. Surety shall be submitted prior to the approval of the Hamilton County Board of Commissioners/commencement of construction. The sureties which are in the form of a Letter of Credit are as follows:

Agent: Fifth Third Bank
Date: February 10, 2004
Number: CIS402158
For: Erosion Control
Amount: \$35,000

Agent: Fifth Third Bank
Date: February 10, 2004
Number: CIS402159
For: Storm Sewers & Subsurface Drains
Amount: \$58,015.00

I believe this proposed drain meets the requirements for Urban Drain Classification as set out in IC 36-9-27-67 to 69. Therefore, this drain shall be designated as an Urban Drain.

I recommend that upon approval of the above proposed drain that the Board also approve the attached non-enforcement request. The request is for the reduction of the regulated drain easement to those easement widths as shown on the conditional secondary plat for Marina Village as recorded in the office of the Hamilton County Recorder.

I recommend the Board set a hearing for this proposed drain for January 24, 2004.

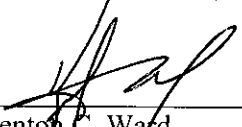

Kenton C. Ward
Hamilton County Surveyor

KCW/pll



December 22, 2003

7172 Graham Road
Indianapolis, IN 46250
317-842-6777
FAX: 317-841-4798
www.picripe.com

Steven Cash
Plan Reviewer
Hamilton County Surveyor's Office
One Hamilton County Square, Suite 188
Noblesville, IN 46060-2230

**MARINA VILLAGE DEVELOPMENT
11691 FALL CREEK ROAD
INDIANAPOLIS, IN 46246**

- Architecture
- Construction Administration
- Engineering
- Geographic Information Services
- Landscape Architecture
- Land Planning
- Land Surveying
- Real Estate Consulting
- Transportation Engineering

Dear Mr. Cash:

The estimated construction cost for the storm sewer on the above referenced project is as follows:

Storm Sewers:	\$35,000.00
Underdrain:	<u>15,000.00</u>
TOTAL	\$50,000.00

This estimate should be suitable for bonding purposes.

Sincerely,

PAUL I. CRIPE, INC.

Joseph A. Sharp, P.E.
Project Engineer

als

FILED

DEC 23 2003

OFFICE OF HAMILTON COUNTY SURVEYOR



O:\2003\030366\2000\docs\ltr122203cash.doc

HCDB-2004-00013

LETTER OF CREDIT NO. CIS402159

PAGE 1

ISSUING BANK:
FIFTH THIRD BANK, (CENTRAL INDIANA)

BENEFICIARY:
HAMILTON COUNTY BOARD OF
COMMISSIONERS
1717 PLEASANT STREET
NOBLESVILLE, IN 46038

APPLICANT:
THE MARINA LIMITED PARTNERSHIP
11691 FALL CREEK ROAD
INDIANAPOLIS, IN 46256

LETTER OF CREDIT NO: CIS402159
ISSUE DATE: FEBRUARY 10, 2004
EXPIRATION DATE: FEBRUARY 10, 2005
EXPIRATION PLACE: AT OUR COUNTERS
AMOUNT: ~~58,015.00~~ USD FIFTY EIGHT THOUSAND FIFTEEN 00/100

WE HEREBY ESTABLISH OUR IRREVOCABLE STANDBY LETTER OF CREDIT NO. CIS402159 IN YOUR FAVOR, AT THE REQUEST AND FOR THE ACCOUNT OF MARINA LIMITED PARTNERSHIP, 11691 FALL CREEK ROAD, INDIANAPOLIS, IN 46256 FOR ANY SUM OR SUMS NOT EXCEEDING \$58,015.00, AVAILABLE UPON PRESENTATION BY THE DIRECTOR OF HAMILTON COUNTY BOARD OF COMMISSIONERS, OR ANY EMPLOYEE ACTING UNDER HIS AUTHORITY, OF A LETTER SIGNED BY THE DIRECTOR OF HAMILTON COUNTY BOARD OF COMMISSIONERS ENUMERATING ANY AND ALL IMPROVEMENTS NOT COMPLETED AS REQUIRED FOR STORM SEWER AND SUB-SURF DRAIN FOR MARINA VILLAGE DUPLEX. THE LETTER SHALL ALSO INDICATE THE ESTIMATED COST OF COMPLETING IMPROVEMENTS.

THE DRAFTS DRAWN UNDER THIS LETTER OF CREDIT MUST STATE, "DRAWN UNDER LETTER OF CREDIT NO. CIS402159 OF FIFTH THIRD BANK, (CENTRAL INDIANA), DATED FEBRUARY 10, 2004." THE AMOUNT OF THE DRAFTS MUST BE NOTED ON THE BACK OF THIS LETTER OF CREDIT BY THE NEGOTIATING BANK.

THIS LETTER OF CREDIT IS EFFECTIVE AS OF FEBRUARY 10, 2004, AND SHALL EXPIRE ON FEBRUARY 10, 2005, BUT SUCH EXPIRATION DATE SHALL BE AUTOMATICALLY EXTENDED FOR A PERIOD OF ONE YEAR, ON FEBRUARY

10, 2005, AND ON EACH SUCCESSIVE EXPIRATION DATE, UNLESS A RELEASE IS RECEIVED FROM HAMILTON COUNTY BOARD OF COMMISSIONERS, OR WE NOTIFY BOTH HAMILTON COUNTY BOARD OF COMMISSIONERS AND THE MARINA LIMITED PARTNERSHIP BY CERTIFIED MAIL, AT LEAST SIXTY (60) DAYS BEFORE THE CURRENT EXPIRATION DATE, THAT WE HAVE DECIDED NOT TO EXTEND THIS LETTER OF CREDIT BEYOND THE CURRENT EXPIRATION DATE. IN THE EVENT OF SUCH NOTIFICATION BY US, THE CREDIT ESTABLISHED BY THIS LETTER OF CREDIT SHALL BE AVAILABLE TO HAMILTON COUNTY BOARD OF COMMISSIONERS UPON ITS SIGHT DRAFT OR DEMAND FOR PAYMENT FOR SIXTY (60) DAYS AFTER RECEIPT OF SUCH NOTICE BY HAMILTON COUNTY BOARD OF COMMISSIONERS, AS SHOWN ON THE SIGNED RETURN RECEIPT.

THE CREDIT ESTABLISHED BY THIS LETTER AND OUR OBLIGATION TO PAY SAME SHALL NOT BE AFFECTED BY THE RECEIVERSHIP, BANKRUPTCY OR INSOLVENCY OF THE MARINA LIMITED PARTNERSHIP OR THE ATTACHMENT OF HIS/HER PROPERTY. NOR SHALL THIS CREDIT OR OUR OBLIGATION TO PAY SAME BE AFFECTED BY ANY SECURITY AGREEMENT BETWEEN THE MARINA LIMITED PARTNERSHIP AND OUR BANK.

WHENEVER THIS LETTER OF CREDIT IS DRAWN UNDER AND IN COMPLIANCE WITH THE TERMS OF THIS LETTER OF CREDIT, WE SHALL PAY THE AMOUNT OF THE DRAFT DIRECTLY TO HAMILTON COUNTY BOARD OF COMMISSIONERS IN ACCORDANCE WITH ITS INSTRUCTIONS.

ALL BANK CHARGES OTHER THAN THOSE OF FIFTH THIRD BANK ARE FOR THE ACCOUNT OF THE BENEFICIARY.

WE ENGAGE WITH YOU THAT DRAFTS DRAWN UNDER AND IN COMPLIANCE WITH THE TERMS OF THIS CREDIT WILL BE HONORED IF NEGOTIATED OR PRESENTED DURING BUSINESS HOURS ON OR BEFORE THE EXPIRATION DATE AT: FIFTH THIRD BANK, INTERNATIONAL TRADE SERVICES, 38 FOUNTAIN SQUARE PLAZA, MD10903C, CINCINNATI, OH 45263.

THIS LETTER OF CREDIT IS SUBJECT TO THE INTERNATIONAL STANDBY PRACTICES/ISP98, ICC PUBLICATION NO. 590.

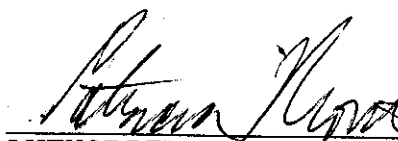
AUTHORIZED SIGNATURE
AUTHORIZED SIGNATURE

HCDB-2004-00014

LETTER OF CREDIT NO. CIS402158

PAGE 1

ISSUING BANK:
FIFTH THIRD BANK, (CENTRAL INDIANA)

BENEFICIARY:
HAMILTON COUNTY BOARD OF
COMMISSIONERS
1717 PLEASANT STREET
NOBLESVILLE, IN 46038

APPLICANT:
THE MARINA LIMITED PARTNERSHIP
11691 FALL CREEK ROAD
INDIANAPOLIS, IN 46256

LETTER OF CREDIT NO: CIS402158
ISSUE DATE: FEBRUARY 10, 2004
EXPIRATION DATE: FEBRUARY 10, 2005
EXPIRATION PLACE: AT OUR COUNTERS
AMOUNT: 35,000.00 USD THIRTY FIVE THOUSAND 00/100

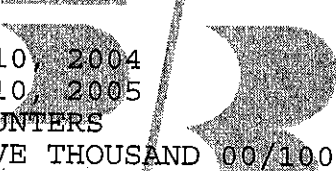

WE HEREBY ESTABLISH OUR IRREVOCABLE STANDBY LETTER OF CREDIT NO. CIS402158 IN YOUR FAVOR, AT THE REQUEST AND FOR THE ACCOUNT OF MARINA LIMITED PARTNERSHIP, 11691 FALL CREEK ROAD, INDIANAPOLIS, IN 46256 FOR ANY SUM OR SUMS NOT EXCEEDING \$35,000.00, AVAILABLE UPON PRESENTATION BY THE DIRECTOR OF HAMILTON COUNTY BOARD OF COMMISSIONERS, OR ANY EMPLOYEE ACTING UNDER HIS AUTHORITY, OF A LETTER SIGNED BY THE DIRECTOR OF HAMILTON COUNTY BOARD OF COMMISSIONERS ENUMERATING ANY AND ALL IMPROVEMENTS NOT COMPLETED AS REQUIRED FOR EROSION CONTROL FOR MARINA VILLAGE DUPLEX. THE LETTER SHALL ALSO INDICATE THE ESTIMATED COST OF COMPLETING IMPROVEMENTS.

THE DRAFTS DRAWN UNDER THIS LETTER OF CREDIT MUST STATE, "DRAWN UNDER LETTER OF CREDIT NO. CIS402158 OF FIFTH THIRD BANK, (CENTRAL INDIANA), DATED FEBRUARY 10, 2004." THE AMOUNT OF THE DRAFTS MUST BE NOTED ON THE BACK OF THIS LETTER OF CREDIT BY THE NEGOTIATING BANK.

THIS LETTER OF CREDIT IS EFFECTIVE AS OF FEBRUARY 10, 2004, AND SHALL EXPIRE ON FEBRUARY 10, 2005, BUT SUCH EXPIRATION DATE SHALL BE AUTOMATICALLY EXTENDED FOR A PERIOD OF ONE YEAR, ON FEBRUARY

10, 2005, AND ON EACH SUCCESSIVE EXPIRATION DATE, UNLESS A RELEASE IS RECEIVED FROM HAMILTON COUNTY BOARD OF COMMISSIONERS, OR WE NOTIFY BOTH HAMILTON COUNTY BOARD OF COMMISSIONERS AND THE MARINA LIMITED PARTNERSHIP BY CERTIFIED MAIL, AT LEAST SIXTY (60) DAYS BEFORE THE CURRENT EXPIRATION DATE, THAT WE HAVE DECIDED NOT TO EXTEND THIS LETTER OF CREDIT BEYOND THE CURRENT EXPIRATION DATE. IN THE EVENT OF SUCH NOTIFICATION BY US, THE CREDIT ESTABLISHED BY THIS LETTER OF CREDIT SHALL BE AVAILABLE TO HAMILTON COUNTY BOARD OF COMMISSIONERS UPON ITS SIGHT DRAFT OR DEMAND FOR PAYMENT FOR SIXTY (60) DAYS AFTER RECEIPT OF SUCH NOTICE BY HAMILTON COUNTY BOARD OF COMMISSIONERS, AS SHOWN ON THE SIGNED RETURN RECEIPT.

THE CREDIT ESTABLISHED BY THIS LETTER AND OUR OBLIGATION TO PAY SAME SHALL NOT BE AFFECTED BY THE RECEIVERSHIP, BANKRUPTCY OR INSOLVENCY OF THE MARINA LIMITED PARTNERSHIP OR THE ATTACHMENT OF HIS/HER PROPERTY. NOR SHALL THIS CREDIT OR OUR OBLIGATION TO PAY SAME BE AFFECTED BY ANY SECURITY AGREEMENT BETWEEN THE MARINA LIMITED PARTNERSHIP AND OUR BANK.

WHENEVER THIS LETTER OF CREDIT IS DRAWN UNDER AND IN COMPLIANCE WITH THE TERMS OF THIS LETTER OF CREDIT, WE SHALL PAY THE AMOUNT OF THE DRAFT DIRECTLY TO HAMILTON COUNTY BOARD OF COMMISSIONERS IN ACCORDANCE WITH ITS INSTRUCTIONS.

ALL BANK CHARGES OTHER THAN THOSE OF FIFTH THIRD BANK ARE FOR THE ACCOUNT OF THE BENEFICIARY.

WE ENGAGE WITH YOU THAT DRAFTS DRAWN UNDER AND IN COMPLIANCE WITH THE TERMS OF THIS CREDIT WILL BE HONORED IF NEGOTIATED OR PRESENTED DURING BUSINESS HOURS ON OR BEFORE THE EXPIRATION DATE AT: FIFTH THIRD BANK, INTERNATIONAL TRADE SERVICES, 38 FOUNTAIN SQUARE PLAZA, MD10903C, CINCINNATI, OH 45263.

THIS LETTER OF CREDIT IS SUBJECT TO THE INTERNATIONAL STANDBY PRACTICES/ISP98, ICC PUBLICATION NO. 590.

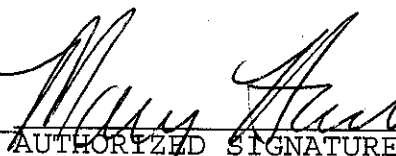

AUTHORIZED SIGNATURE
AUTHORIZED SIGNATURE

FINDINGS AND ORDER
CONCERNING THE MAINTENANCE OF THE
Bridgewater Drain, Marina Village Arm

On this *24th day of January 2005*, the Hamilton County Drainage Board has held a hearing on the Maintenance Report and Schedule of Assessments of the *Bridgewater Drain, Marina Village Arm*.

Evidence has been heard. Objections were presented and considered. The Board then adopted the original/amended Schedule of Assessments. The Board now finds that the annual maintenance assessment will be less than the benefits to the landowners and issues this order declaring that this Maintenance Fund be established.

HAMILTON COUNTY DRAINAGE BOARD



President



Member

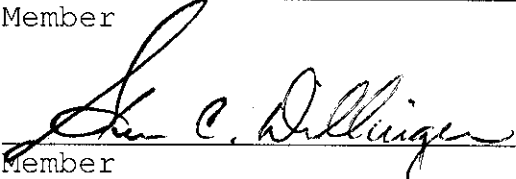

Member

Attest: 

BEFORE THE HAMILTON COUNTY DRAINAGE BOARD
IN THE MATTER OF
Bridgewater Drain, Marina Village Arm

NOTICE

To Whom It May Concern and: _____

Notice is hereby given of the hearing of the Hamilton County Drainage Board on the **Bridgewater Drain, Marina Village Arm** on **January 24, 2005** at **9:10 A.M.** in Commissioners Court, Hamilton County Judicial Center, One Hamilton County Square, Noblesville, Indiana, and which construction and maintenance reports of the Surveyor and the Schedule of Assessments made by the Drainage Board have been filed and are available for public inspection in the office of the Hamilton County Surveyor.

Hamilton County Drainage Board

Attest: Lynette Mosbaugh

ONE TIME ONLY

BEFORE THE HAMILTON COUNTY DRAINAGE BOARD
IN THE MATTER OF THE

Bridgewater Drain, Marina Village Arm

NOTICE

Notice is hereby given pursuant to Section 405 of the 1965 Indiana Drainage Code that this Board, prior to final adjournment on **January 24, 2005** has issued an order adopting the Schedule of Assessments, filed the same and made public announcement thereof at the hearing and ordered publication. If judicial review of the findings and order of the Board is not requested pursuant to Article Eight of this code within twenty (20) days from the date of this publication, the order shall be conclusive.

Hamilton County Drainage Board

Attest: Lynette Mosbaugh

ONE TIME ONLY



7172 Graham Road
Indianapolis, IN 46250
317-842-6777
FAX: 317-841-4798
www.cripe.biz

- Architecture
- Construction Administration
- Engineering
- Geographic Information Services
- Landscape Architecture
- Land Planning
- Land Surveying
- Real Estate Consulting
- Transportation Engineering

CERTIFICATE OF COMPLETION AND COMPLIANCE

To: Hamilton County Surveyor

Re: Marina Village

I hereby certify that:

1. I am a Registered Engineer in the State of Indiana.
2. I am familiar with the plans and specifications for the above referenced subdivision.
3. I have personally observed and supervised the completion of the drainage facilities for the above referenced subdivision.
4. The drainage facilities within the above referenced subdivision to the best of my knowledge, information and belief have been installed and completed in conformity with all plans and specifications.

Signature: Joseph A. Sharp Date: 8-25, 2004
Joseph A. Sharp, P.E. #15179





SURVEYOR'S OFFICE

Hamilton County

Kenton C. Ward, Surveyor

Phone (317) 776-8495

Tax (317) 776-9628

Suite 188

One Hamilton County Square

Noblesville, Indiana 46060-2230

To: Hamilton County Drainage Board

June 2, 2006

Re: Bridgewater Drain: Marina Village Arm

Attached are as-builts, certificate of completion & compliance, and other information for Marina Village. An inspection of the drainage facilities for this section has been made and the facilities were found to be complete and acceptable.

During construction, changes were made to the drain, which will alter the plans submitted with my report for this drain-dated October 25, 2004. The report was approved by the Board at the hearing held January 24, 2005. (See Drainage Board Minutes Book 8, Pages 151-152)
The changes are as follows:

Structure:	Length:	Size	Material:	Up Invert:	Dn Invert	Grade:	Changes(ft):
703-702	22.9	12	RCP	786.39	785.92	2.05	-5.1
702-701	69.7	12	RCP	785.8	785.02	1.13	-7.3
706-705	23	12	RCP	785.86	785.56	1.3	-5
705-704	27.2	12	RCP	785.33	784.98	1.29	-0.8
709-708	22	12	RCP	785.53	785.17	1.57	-0.928
708-707	18	18	RCP	785.17	784.98	0.69	-0.812
711-710	113.4	12	RCP	785.53	785.17	1.57	1.4
714-713	13.2	12	RCP	786.95	786.72	1.74	3.2
713-712	23.5	12	RCP	786.73	786.51	0.94	4.5
712-710	137.6	15	RCP	786.45	785.65	0.49	-1.4
710-708	100.6	18	RCP	785.36	785.17	0.19	0.6

6" SSD Streets:

Marina Village Dr.	905
Marina View Dr.	245.5
Total:	2301

6" SSD Lots:

Blk A,B,C,D,F	363
Lots 9-10	62
Total:	425

RCP Pipe Totals:

12	314.9
15	137.6
18	118.6
Total:	571.1

The length of the drain due to the changes described above is now **3297.1 feet**.

The non-enforcement was approved by the Board at its meeting on January 24, 2005 and recorded under instrument #200500013401.

The following sureties were guaranteed by Fifth Third Bank and released by the Board on its January 9, 2006 meeting.

Bond-LC No: CIS402159
Insured For: Storm Sewers, SSD
Amount: \$58,015.00
Issue Date: February 10, 2004

Bond-LC No: CIS402158
Insured For: Erosion Control
Amount: \$35, 000.00
Issue Date: February 10, 2004

I recommend the Board approve the drain's construction as complete and acceptable.

Sincerely,

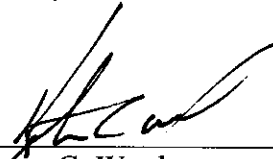

Kenton C. Ward,
Hamilton County Surveyor

KCW/slm

OWNER:

THE MARINA LIMITED PARTNERSHIP

11691 FALL CREEK ROAD
INDIANAPOLIS, IN 46256

CONTACT:

Ph. (317) 845-0270 FAX (317) 845-0766

ENGINEER:

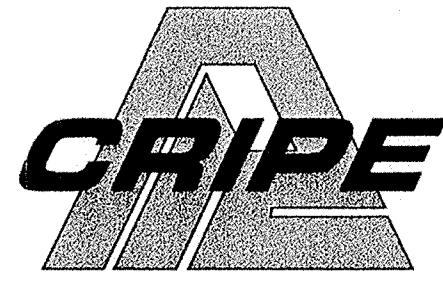

ENGINEER
7172 GRAHAM ROAD
INDIANAPOLIS, INDIANA 46250
Ph. (317) 842-6777 FAX (317) 841-4798

CONSTRUCTION PLANS FOR MARINA VILLAGE



This information was gathered for input into the Hamilton County Geographical Information System. This document is considered an official record of the GIS.

Entry Date: 5-4-06

Entered by: Suzanne Mills

STORM ASBUILTS

STORM ASBUILTS

STORM ASBUILTS

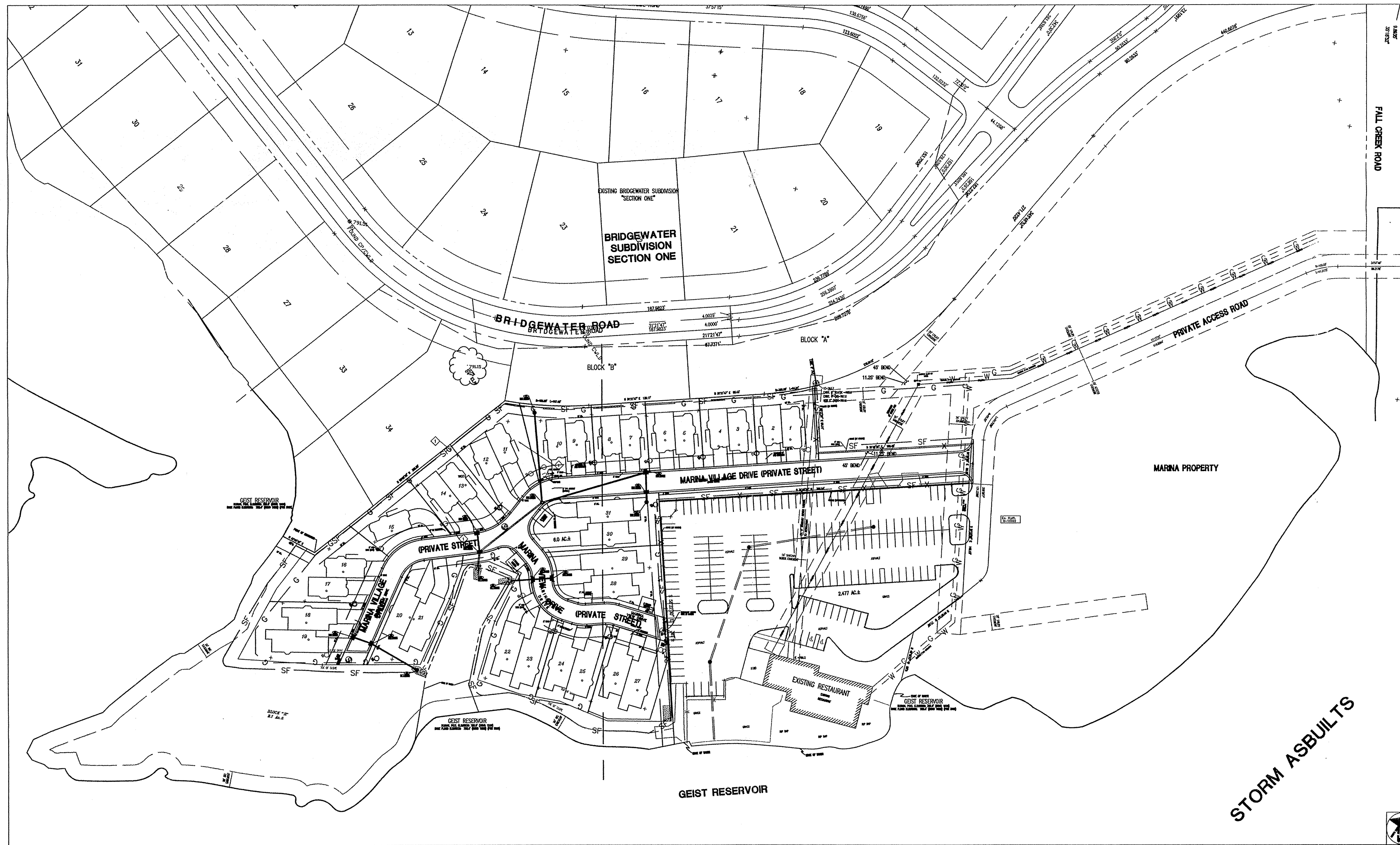

AS BUILT

date 8/25/04

PROJECT DATA

Project Address: **6.00 Acres**
Project Area: **6.00 Acres**
Parking Spaces Provided: **82**
Guest Spaces: **6**
Total Spaces Provided: **88**

ASBUILT INDEX

SHT	DESCRIPTION
CS	COVER SHEET
E100	MAP SHEET
E101	EXISTING CONDITIONS
E102	DEMOLITION PLAN
E203	SITE DETAILS
C204	SITE DEVELOPMENT PLAN
C205	SITE DEVELOPMENT PLAN
E301	GRADING PLAN
E302	GRADING PLAN
E401	EROSION CONTROL PLAN
E402	EROSION CONTROL PLAN
E403	EROSION CONTROL DETAILS
E404	CONSTRUCTION SEQUENCE FOR BLDG. SITE EROSION CONTROL PRACTICES
E501	UTILITY PLAN
E502	UTILITY PLAN
E601	ROAD PLAN & PROFILE
E602	ROAD PLAN & PROFILE
E603	ROAD PLAN & PROFILE
C701	STORM PLAN & PROFILES
C702	STORM PLAN & PROFILES
C703	STORM DETAILS
E801	SANITARY PLAN & PROFILES FORCE MAIN 1
E802	SANITARY PLAN & PROFILES FORCE MAIN 1
E803	SANITARY PLAN & PROFILES FORCE MAIN 2
E804	SANITARY DETAILS
E901	WATER LINE PLAN
E902	WATER LINE DETAILS

BENCHMARKS

REFERENCE BENCHMARK:
IFC&WRC benchmark tablet stamped "HAM 2 1956" set in the northeast end of the northwest abutment of the Fall Creek Road bridge over Geist Reservoir.
Elev. 798.214
(NGVD 1929)

CONTACT CO. / PERSON FOR

	NAME	PHONE NO.	FAX NO.
OWNER	MARINA LIMITED PART.	(317) 845-0270	845-0766
DEVELOPER	MARINA LIMITED PART.	(317) 845-0270	845-0766
POWER	CINERGY (PS)	(317) 776-5316	
CAS	VECTREN	(765) 648-3244	
TELEPHONE	AMERITECH	(317) 252-4267	
CABLE	INSIGHT CABLE	(317) 776-0660	773-5439
WATER	INDPLS. WATER CO.	(317) 327-5772	
SURVEYOR	KENT WARD	(317) 776-8495	776-9628
ENGINEER	STEVE HUNTLEY	(317) 773-4614	776-6363
PLANNING	HAM. CTY. HWY.	(317) 773-7770	776-9614
TRAFFIC	DMD	(317) 327-8461	
SANITARY	HAM. CTY. SURV.	(317) 776-8495	
DRAINAGE	HAM. CTY. SWCD	(317) 773-1406	
EROSION			

"HOLEY MOLEY" SAYS CALL AT LEAST TWO FULL WORKING DAYS BEFORE YOU DIG. IT'S THE LAW.
1-800-382-5544
CALL TOLL FREE
1-800-428-5200
FOR CALLS OUTSIDE OF INDIANA

CRIFE TEAM 317-842-6777 FAX-841-4798 EXT. NO.

PROJECT MGR	RICHARD RADABAUGH	651
PROJECT ENGR	JOSEPH SHARP	675
PROJECT SURVEYOR	DENNIS SINGER	635
PROJECT LAND PLANNER	CHUCK BRIDENTHAL	648
CAD TECH.	CATHERINE MESCALL	749
QUALITY ASSURANCE	TOM SCHELLENBERGER	622

DWG. TYPE FILE NUMBER

RECORD DRAWING

COVER SHEET
MARINA VILLAGE
The Marina Limited Partnership
11691 Fall Creek Road
Indianapolis, IN 46256
Ph. (317) 845-0270
Fax. (317) 845-0766

REGISTERED PROFESSIONAL ENGINEER
No. 15179
STATE OF INDIANA
8-25-04

Drawn By: [Signature]
ASBUILTS DRAWN BY: CMQ 8/18/04
Checked By:

Scale: 1" = 50'
Sheet: **CS**
Date: **09-04-03**
Project Number: 030366-20000

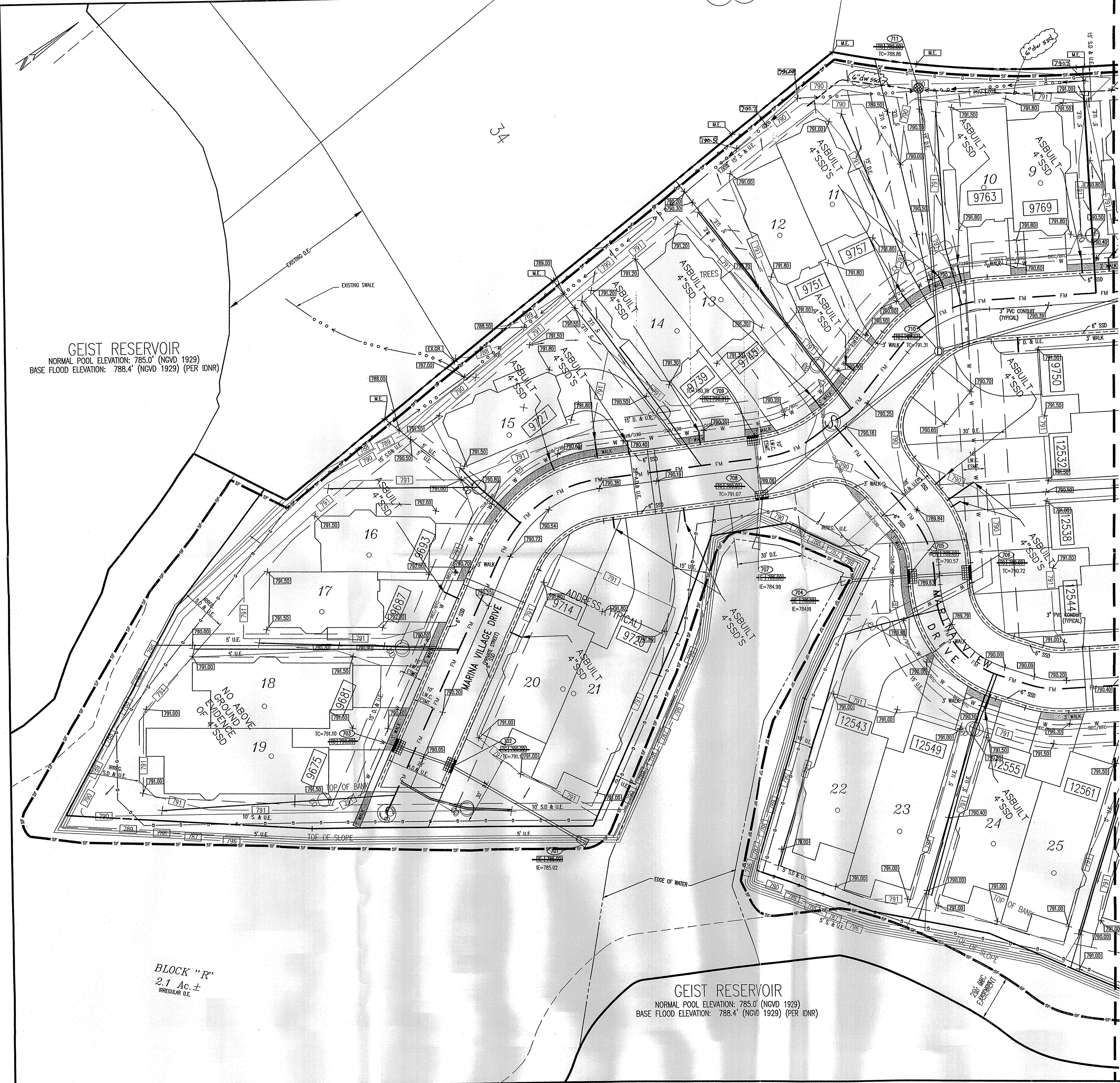

MATCHLINE SHEET C205

GEIST RESERVOIR
 NORMAL POOL ELEVATION: 785.0' (NGVD 1929)
 BASE FLOOD ELEVATION: 788.4' (NGVD 1929) (PER IDNR)

GEIST RESERVOIR
 NORMAL POOL ELEVATION: 785.0' (NGVD 1929)
 BASE FLOOD ELEVATION: 788.4' (NGVD 1929) (PER IDNR)

BLOCK "R"
 2.1 Ac. ±
 IRREGULAR D.E.

This information was gathered for input into the Hamilton County Geographic Information System. This document is considered an GIS.
 Entry Date: 5-4-06
 Entered by: Suzanne L. HIG

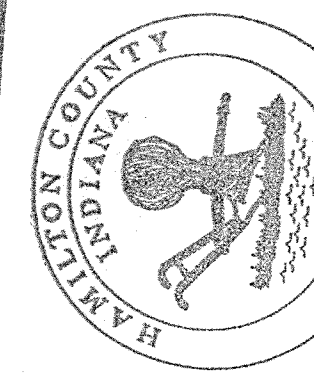

AS BUILT
 date 8/25/04

RECORD DRAWING
 (Revised 9-27-04) (Add 6" ssd Lots 1-11)

"HOLEY MOLEY" SAYS CALL AT LEAST TWO FULL WORKING DAYS BEFORE YOU DIG... IT'S THE LAW.

 1-800-382-5544
 1-800-428-5200
 FOR CALLS OUTSIDE OF INDIANA

CAUTION
 LOCATIONS OF ALL EXISTING UNDERGROUND UTILITIES SHOWN ON THIS PLAN ARE BASED UPON ABOVE GROUND EVIDENCE (including, but not limited to, manholes, inlets, valves, and marks made upon the ground by others) AND ARE SPECULATIVE IN NATURE. THERE MAY ALSO BE OTHER EXISTING UNDERGROUND UTILITIES FOR WHICH THERE IS NO ABOVE GROUND EVIDENCE OR FOR WHICH NO ABOVE GROUND EVIDENCE WAS OBSERVED. THE EXACT LOCATIONS OF SAID EXISTING UNDERGROUND UTILITIES SHOULD BE VERIFIED BY THE CONTRACTOR PRIOR TO ANY AND ALL CONSTRUCTION.

Revision	Date	Description

ARCHITECTURE
 CIVIL ENGINEERS
 LANDSCAPE ARCHITECTURE
 LAND SURVEYORS
 TRANSPORTATION ENGINEERS
 GS

7172 GRAHAM ROAD
 INDIANAPOLIS, INDIANA 46250
 (317) 842-6777 FAX (317) 841-4798
 E-Mail: cripe@crife.biz

CRIFE

SITE DEVELOPMENT PLAN
MARINA VILLAGE
 The Marina Limited Partnership
 11691 Fall Creek Road
 Indianapolis, IN 46256
 PHONE: (317) 845-0270 FAX: (317) 845-0788

CERTIFIED BY:

8-25-04

Drawn By:
 ASBUILTS DRAWN BY: CMQ 8/18/04

Checked By:

Quality Assurance:

Scale: 1" = 20'

Sheet: **C204**

Date: 09-04-03

Project Number: 030366-20000

SHEET C204



This information was gathered for input into the Hamilton County Geographical Information System. This document is considered an GIS.

Entry Date: 5-4-06
Entered by: Suzanne Mills

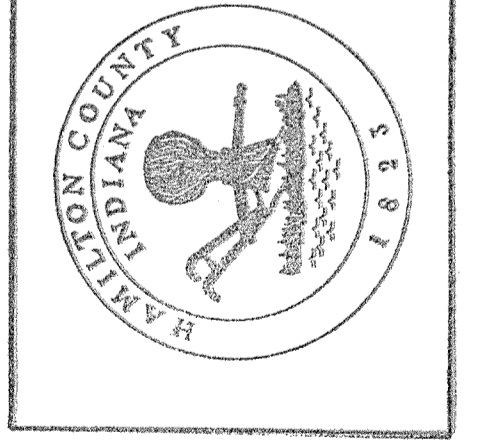

AS BUILT
date 8/25/04

RECORD DRAWING
(Revised 9-27-04) (Add 6" ssd Lots 1-11)

"HOLEY MOLEY" SAYS CALL AT LEAST TWO FULL WORKING DAYS BEFORE YOU DIG... IT'S THE LAW.

1-800-382-5544
CALL TO FREE
1-800-428-5200
FOR CALLS OUTSIDE OF INDIANA



CAUTION
LOCATIONS OF ALL EXISTING UNDERGROUND UTILITIES SHOWN ON THIS PLAN ARE BASED UPON ABOVE GROUND EVIDENCE (including, but not limited to, manholes, pits, valves, and marks made upon the ground by others) AND ARE SPECULATIVE IN NATURE. THERE MAY ALSO BE OTHER EXISTING UNDERGROUND UTILITIES FOR WHICH THERE IS NO ABOVE GROUND EVIDENCE OR FOR WHICH NO ABOVE GROUND EVIDENCE WAS OBSERVED. THE EXACT LOCATIONS OF SAID EXISTING UNDERGROUND UTILITIES SHOULD BE VERIFIED BY THE CONTRACTOR PRIOR TO ANY AND ALL CONSTRUCTION.

Revision	Date	Description

ARCHITECTURE
CIVIL ENGINEERS
LAND PLANNING
LAND SURVEYORS
TRANSPORTATION ENGINEERS
GIS

7172 GRAHAM ROAD
INDIANAPOLIS, INDIANA 46250
(317) 842-6777 FAX (317) 841-4798
E-Mail cripe@cripe.biz

CRIFE

SITE DEVELOPMENT PLAN
MARINA VILLAGE
The Marina Limited Partnership
11691 Fall Creek Road
Indianapolis, IN 46256

PHONE: (317) 945-0270 FAX: (317) 945-0786

CERTIFIED BY: *Joseph A. Sharp*
JOSEPH A. SHARP
REGISTERED
No. 16179
STATE OF INDIANA
PROFESSIONAL ENGINEER

8-25-04
Drawn By:
ASBUILT DRAWN BY: CMO 8/18/04
Checked By:

Quality Assurance:
Scale: 0' = 1" = 20'
Sheet
C205
Date: 08-04-03
Project Number: 030366-20000

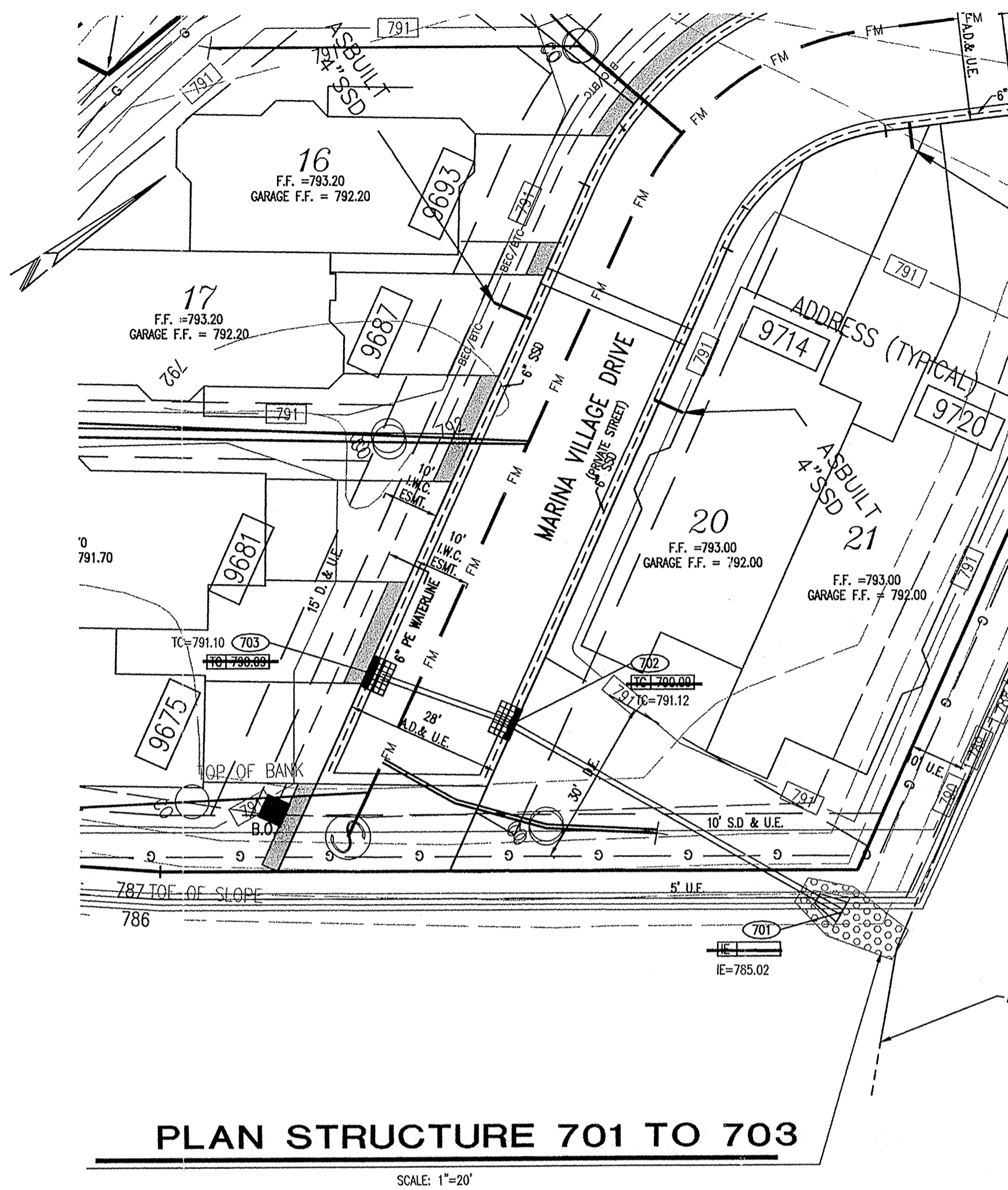

PLAN STRUCTURE 701 TO 703

SCALE: 1"=20'

PLAN STRUCTURE 707 TO 709

SCALE: 1"=20'

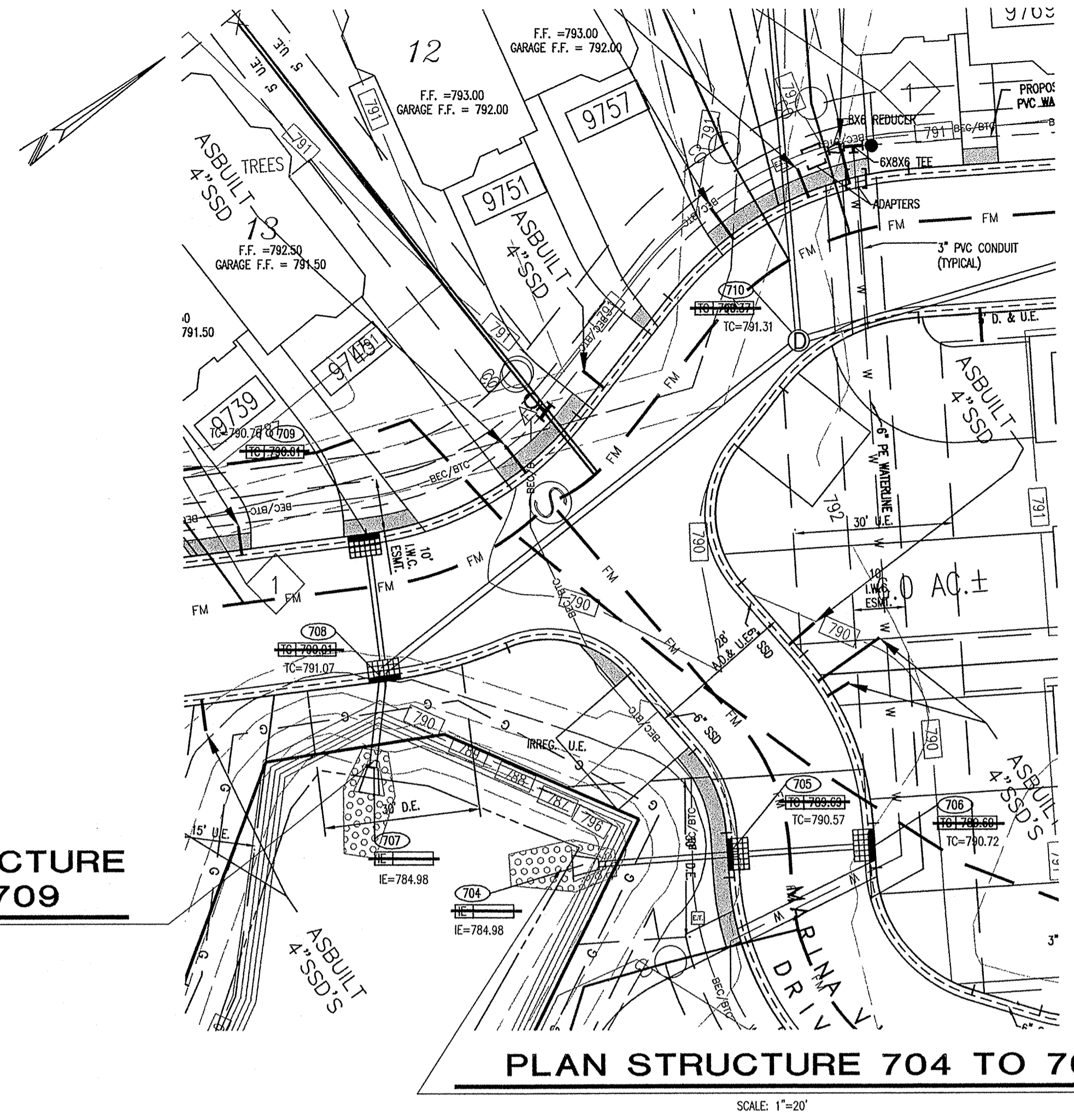

PLAN STRUCTURE 704 TO 706

SCALE: 1"=20'

STORM SEWER PLAN AND PROFILE NOTES:

- OCCUPATIONAL SAFETY AND HEALTH ADMINISTRATION (OSHA) STANDARDS FOR EXCAVATIONS: FINAL RULE 29 CFR PART 1926, SUBPART "P" APPLIES TO ALL EXCAVATIONS EXCEEDING FIVE (5) FEET IN DEPTH.
- IN ADDITION, EXCAVATIONS EXCEEDING TWENTY (20) FEET IN DEPTH REQUIRE THE DESIGN OF A TRENCH SAFETY SYSTEM BY A REGISTERED PROFESSIONAL ENGINEER.
- ALL STRUCTURES SHALL HAVE CASTINGS, JOINTS, LIFT RINGS, STEPS AND PIPE CONNECTIONS WELL GROUTED, TROWELED SMOOTH AND BRUSH FINISHED.
- ALL STRUCTURES (IE: MANHOLES, INLETS) SHALL HAVE POURED FLOW LINES AND BENCH WALLS. THE FLOW LINES AND BENCHWALLS SHALL BE TROWELED SMOOTH AND BRUSH FINISHED.
- FIELD ADJUSTMENTS OF TOP OF CASTING (T.O.C.) OF STRUCTURES MAY BE REQUIRED TO MEET FIELD CONDITIONS: ADJUSTMENTS EXCEEDING FIVE TENTHS (0.5) OF A FOOT MUST BE APPROVED BY THE ENGINEER TO DETERMINE THE INTEGRITY OF THE STRUCTURE. AT NO COST TO THE OWNER.
- STORM STRUCTURES WITH INLET CASTINGS SHALL BE SET TO MAINTAIN A POSITIVE DRAINAGE FLOW INTO THE STRUCTURE.
- STORM PIPE INVERTS AT OUTLET STRUCTURES (IE: END SECTIONS), AND PIPE LENGTHS MAY REQUIRE FIELD ADJUSTMENTS TO MEET ACTUAL FIELD CONDITIONS.
- FULL DEPTH GRANULAR BACKFILL SHALL BE REQUIRED UNDER AND WITHIN (5) FEET OF ALL PAVED AREAS, INCLUDING CURBS, EDGE OF PAVEMENT, AND SIDEWALKS.
- SEE STORM DETAILS ON SHEET C703.
- PIPES LENGTHS ARE MEASURED FROM CENTER OF STRUCTURE TO CENTER OF STRUCTURE AND INCLUDE END SECTIONS.
- THE CONNECTION OF THE PROPOSED STORM SEWER TO AN EXISTING BRICK STRUCTURE MUST BE DONE ACCORDING TO THE FOLLOWING CONDITIONS:
 - REHABILITATE AND COAT THE ENTIRE INTERIOR OF THE MANHOLE WITH NON-SHRINK GROUT.
 - AT THE POINT OF CONNECTION OF THE PROPOSED PIPE, PLACE A THREE FOOT (3') DIAMETER BY A MINIMUM SIX INCH (6") THICK, 4,000 PSI CONCRETE COLLAR WITH 4x4x10 GAUGE WIRE MESH OVER THE EXTERIOR OF THE MANHOLE.
 - ONCE THE CORE HAS BEEN MADE, INSTALL A RUBBER BOOT.

SHOULD THE INTEGRITY OF THE MANHOLE BE COMPROMISED, THE ENTIRE STRUCTURE MUST BE REPLACED WITH A STANDARD MANHOLE STRUCTURE IN ACCORDANCE WITH THE INDIANAPOLIS SANITARY SEWER DISTRICT STANDARDS, MAY 1989, AND ITS ADDENDUMS.

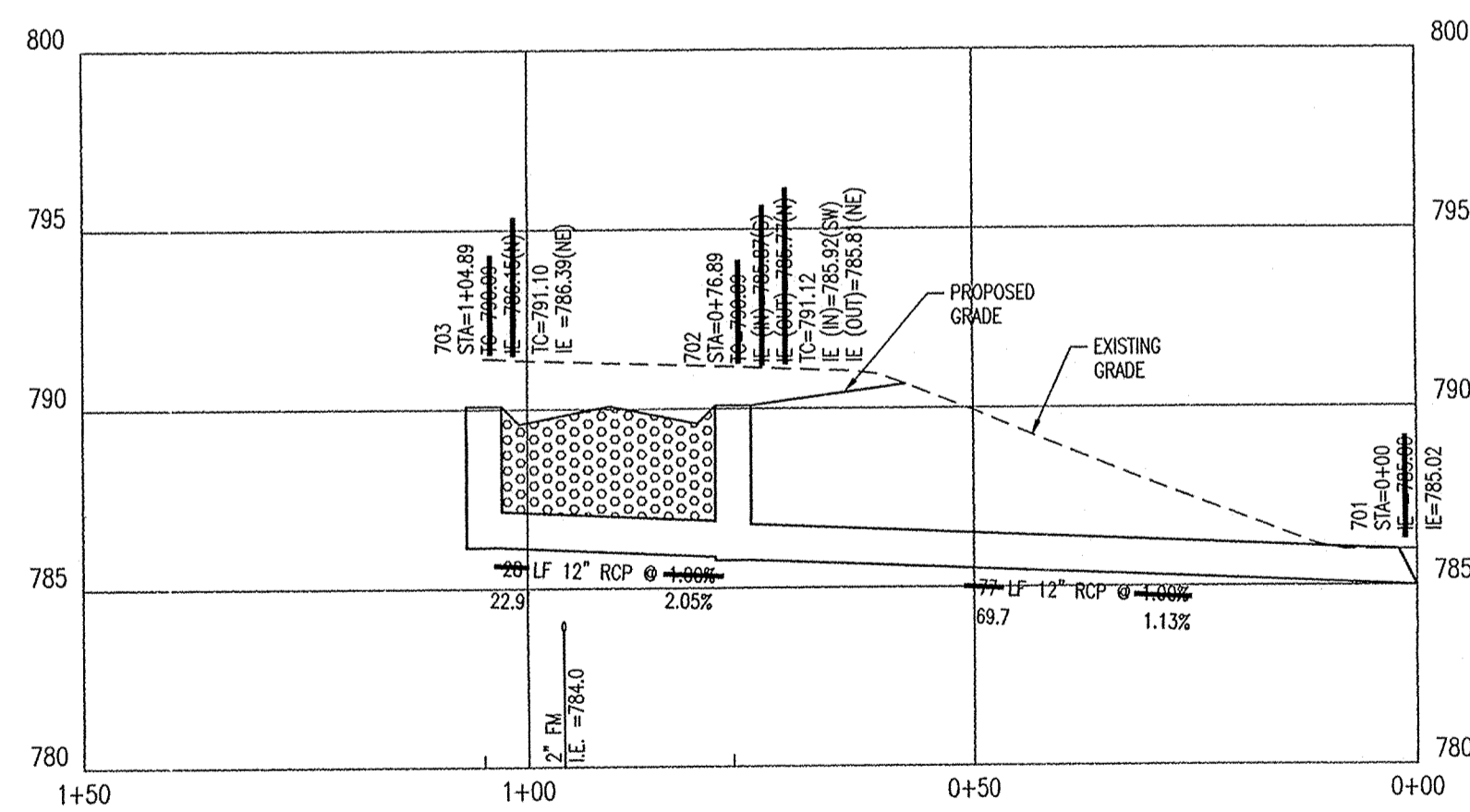
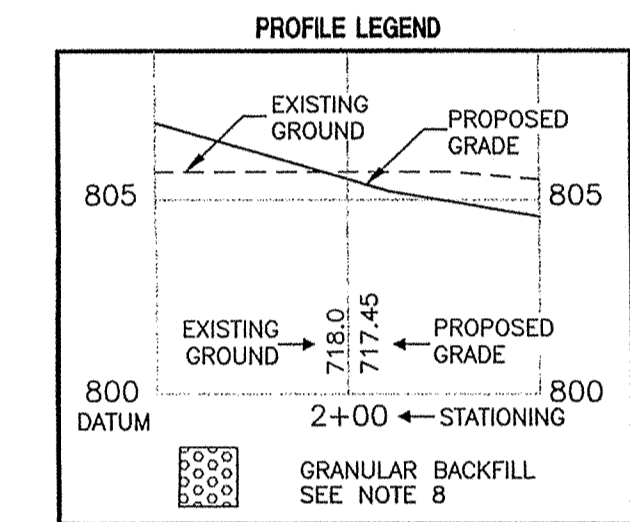

PROFILE STRUCTURE 701 TO 703

HORIZONTAL SCALE: 1"=20'
VERTICAL SCALE: 1"=5'

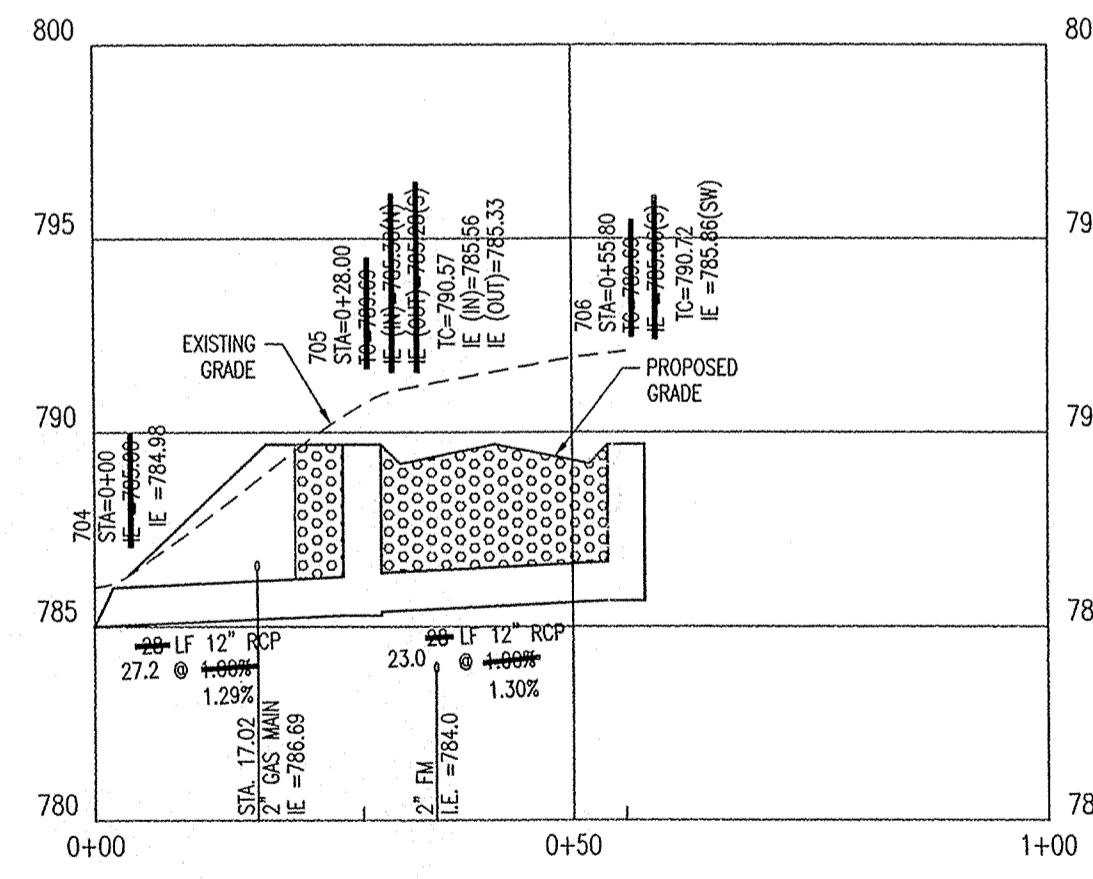

PROFILE STRUCTURE 704 TO 706

HORIZONTAL SCALE: 1"=20'
VERTICAL SCALE: 1"=5'

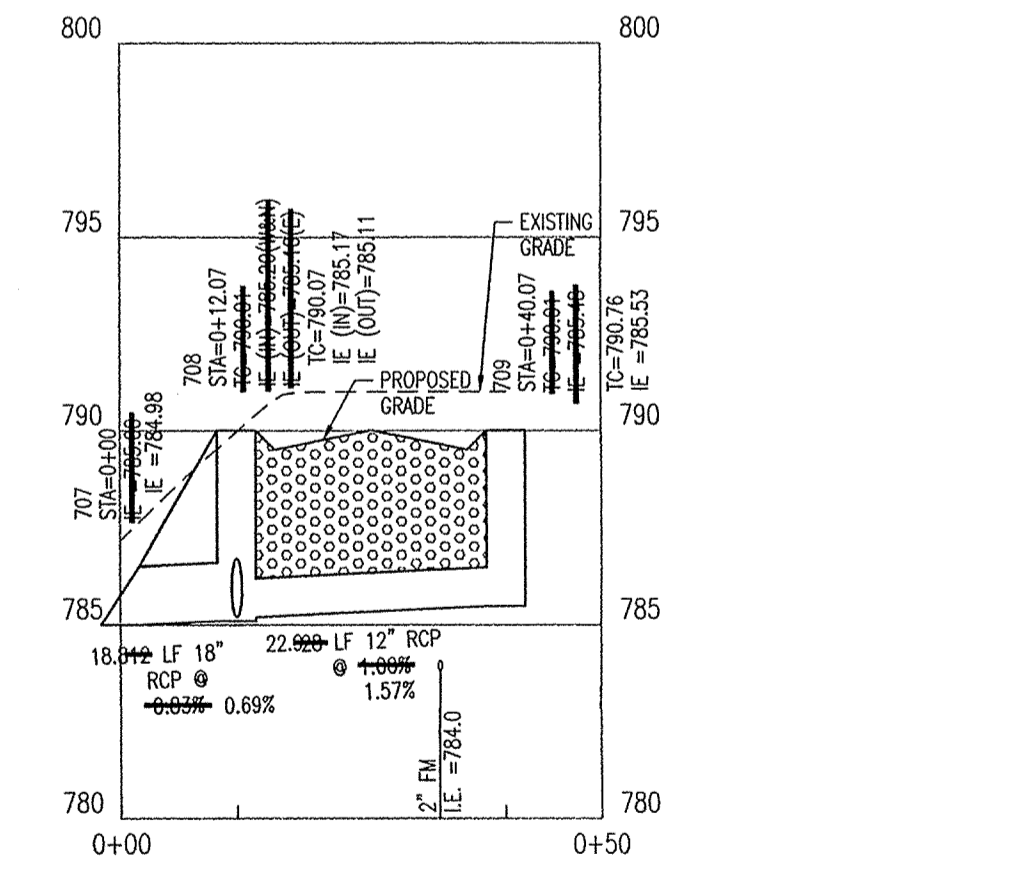

PROFILE STRUCTURE 707 TO 709

HORIZONTAL SCALE: 1"=20'
VERTICAL SCALE: 1"=5'

This information was gathered for input into the Hamilton County Geographical Information System. This document is considered an official record of the GIS.
Entry Date: 5-4-06
Entered by: *Diana Mills*

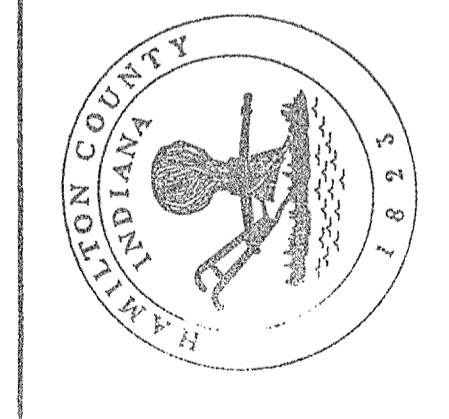

AS BUILT
date 8/25/04
RECORD DRAWING

"HOLEY MOLEY" SAYS CALL AT LEAST TWO FULL WORKING DAYS BEFORE YOU DIG "IT'S THE LAW."
CAUTION
LOCATIONS OF ALL EXISTING UNDERGROUND UTILITIES SHOWN ON THIS PLAN ARE BASED UPON ABOVE GROUND EVIDENCE (INCLUDING, BUT NOT LIMITED TO, MANHOLES, INLETS, VALVES, AND MARKS MADE UPON THE GROUND BY OTHERS) AND ARE SPECULATIVE IN NATURE. THERE MAY ALSO BE OTHER EXISTING UNDERGROUND UTILITIES FOR WHICH THERE IS NO ABOVE GROUND EVIDENCE OR FOR WHICH NO ABOVE GROUND EVIDENCE WAS OBSERVED. THE EXACT LOCATIONS OF SAID EXISTING UNDERGROUND UTILITIES SHOULD BE VERIFIED BY THE CONTRACTOR PRIOR TO ANY AND ALL CONSTRUCTION.



1-800-382-5544
CALL TOLL FREE
1-800-428-5200
FOR CALLS OUTSIDE OF INDIANA

STORM PLAN AND PROFILES
MARINA VILLAGE
The Marina Limited Partnership
11691 Fall Creek Road
Indianapolis, IN 46256

CERTIFIED BY:



Drawn By:
ASBUILTS DRAWN BY: CMQ 8/18/04
Checked By:

Quality Assurance:

Scale: 1" = 20'

Sheet: C701

Date: 09-04-03

Project Number: 030366-20000

ARCHITECTURE
CIVIL ENGINEERS
LANDSCAPE ARCHITECTURE
LAND SURVEYORS
TRANSPORTATION ENGINEERS
GIS

7172 GRAHAM ROAD
INDIANAPOLIS, INDIANA 46250
(317) 842-6777 FAX (317) 841-4798
E-Mail: crpe@crpe.biz

CRPE

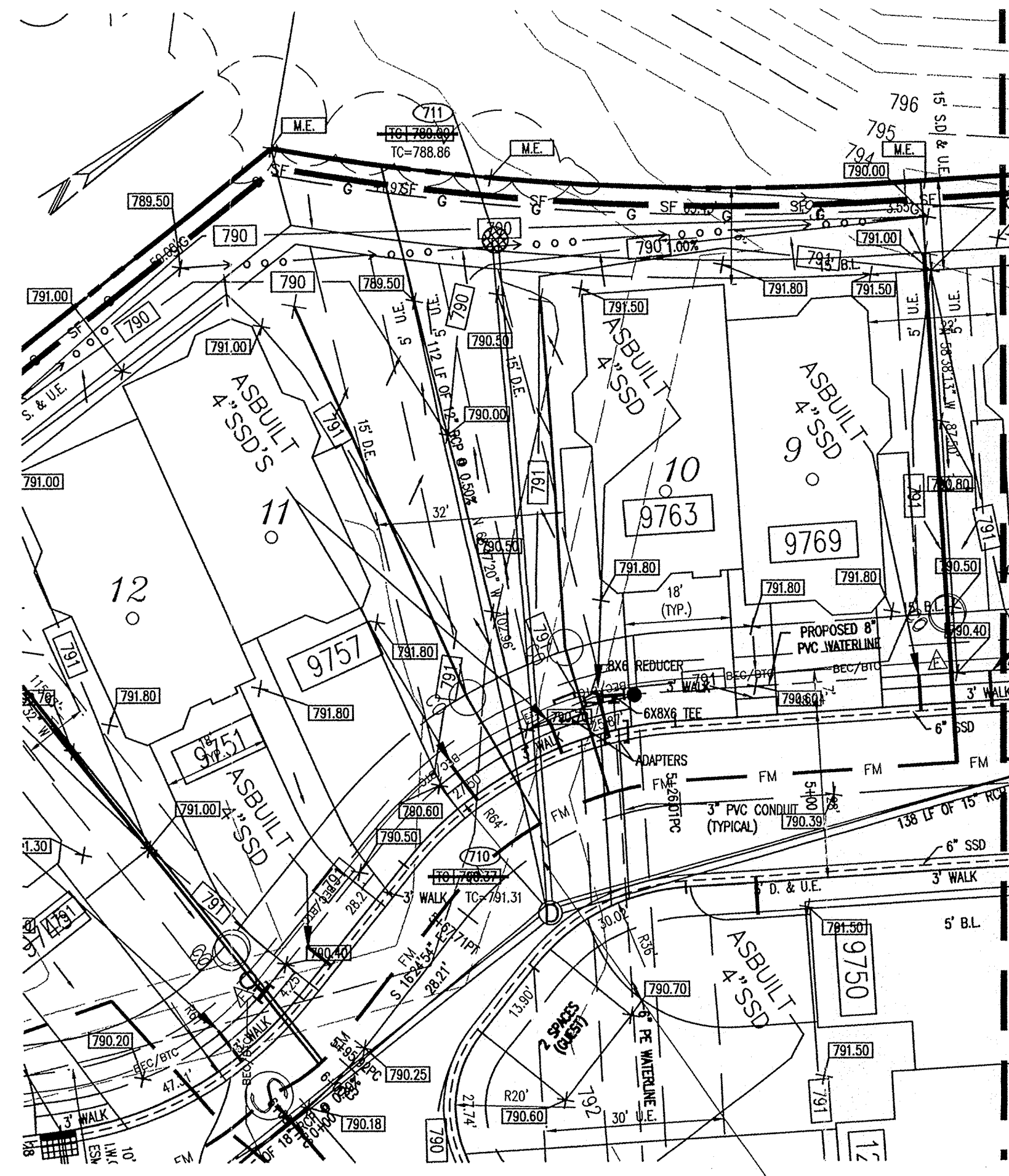

PLAN STRUCTURE 710 TO 711
SCALE: 1"=20'

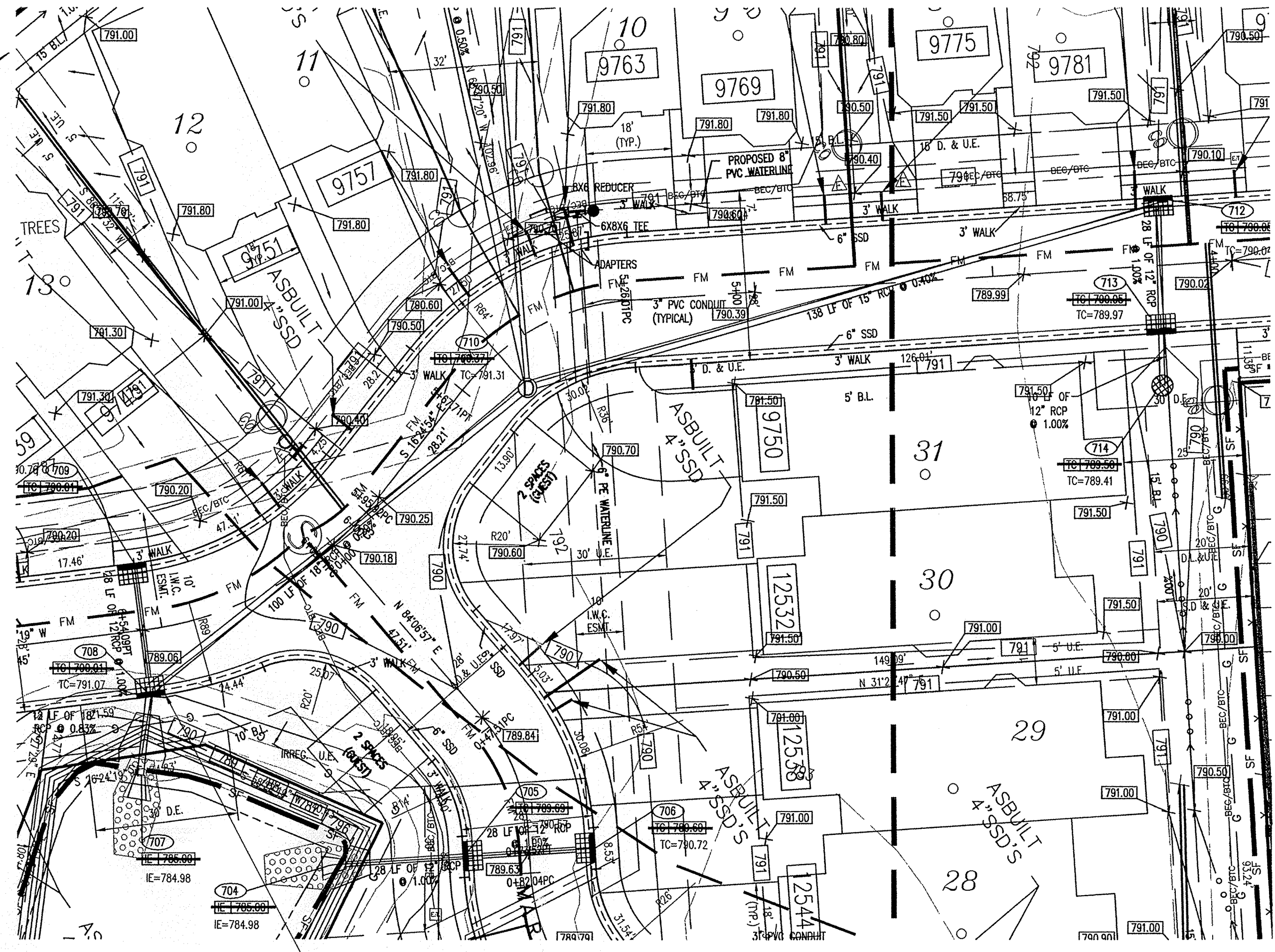

PLAN STRUCTURE 708 TO 714
SCALE: 1"=20'

- STORM SEWER PLAN AND PROFILE NOTES:**
- OCCUPATIONAL SAFETY AND HEALTH ADMINISTRATION (OSHA) STANDARDS FOR EXCAVATIONS; FINAL RULE 29 CFR PART 1926, SUBPART "P" APPLIES TO ALL EXCAVATIONS EXCEEDING FIVE (5) FEET IN DEPTH.
 - IN ADDITION, EXCAVATIONS EXCEEDING TWENTY (20) FEET IN DEPTH REQUIRE THE DESIGN OF A TRENCH SAFETY SYSTEM BY A REGISTERED PROFESSIONAL ENGINEER.
 - ALL STRUCTURES SHALL HAVE CASTINGS, JOINTS, LIFT RINGS, STEPS AND PIPE CONNECTIONS WELL GROUTED, TROWELED SMOOTH AND BRUSH FINISHED.
 - ALL STRUCTURES (IE: MANHOLES, INLETS) SHALL HAVE POURED FLOW LINES AND BENCH WALLS. THE FLOW LINES AND BENCHWALLS SHALL BE TROWELED SMOOTH AND BRUSH FINISHED.
 - FIELD ADJUSTMENTS OF TOP OF CASTING (T.C.) OF STRUCTURES MAY BE REQUIRED TO MEET FIELD CONDITIONS. ADJUSTMENTS EXCEEDING FIVE TENTHS (0.5) OF A FOOT MUST BE APPROVED BY THE ENGINEER TO DETERMINE THE INTEGRITY OF THE STRUCTURE. AT NO COST TO THE OWNER.
 - STORM STRUCTURES WITH INLET CASTINGS SHALL BE SET TO MAINTAIN A POSITIVE DRAINAGE FLOW INTO THE STRUCTURE.
 - STORM PIPE INVERTS AT OUTLET STRUCTURES (IE: END SECTIONS), AND PIPE LENGTHS MAY REQUIRE FIELD ADJUSTMENTS TO MEET ACTUAL FIELD CONDITIONS.
 - FULL DEPTH GRANULAR BACKFILL SHALL BE REQUIRED UNDER AND WITHIN (5) FEET OF ALL PAVED AREAS, INCLUDING CURBS, EDGE OF PAVEMENT, AND SIDEWALKS.
 - SEE STORM DETAILS ON SHEET C703.
 - PIPES LENGTHS ARE MEASURED FROM CENTER OF STRUCTURE TO CENTER OF STRUCTURE AND INCLUDE END SECTIONS.
 - THE CONNECTION OF THE PROPOSED STORM SEWER TO AN EXISTING BRICK STRUCTURE MUST BE DONE ACCORDING TO THE FOLLOWING CONDITIONS:
 - REHABILITATE AND COAT THE ENTIRE INTERIOR OF THE MANHOLE WITH NON-SHRINK GROUT.
 - AT THE POINT OF CONNECTION OF THE PROPOSED PIPE, PLACE A THREE FOOT (3') DIAMETER BY A MINIMUM SIX INCH (6") THICK, 4,000 PSI CONCRETE COLLAR WITH 4x4x10 GAUGE WIRE MESH OVER THE EXTERIOR OF THE MANHOLE.
 - ONCE THE CORE HAS BEEN MADE, INSTALL A RUBBER BOOT.
- SHOULD THE INTEGRITY OF THE MANHOLE BE COMPROMISED, THE ENTIRE STRUCTURE MUST BE REPLACED WITH A STANDARD MANHOLE STRUCTURE IN ACCORDANCE WITH THE INDIANAPOLIS SANITARY SEWER DISTRICT STANDARDS, MAY 1989, AND ITS ADDENDUMS.

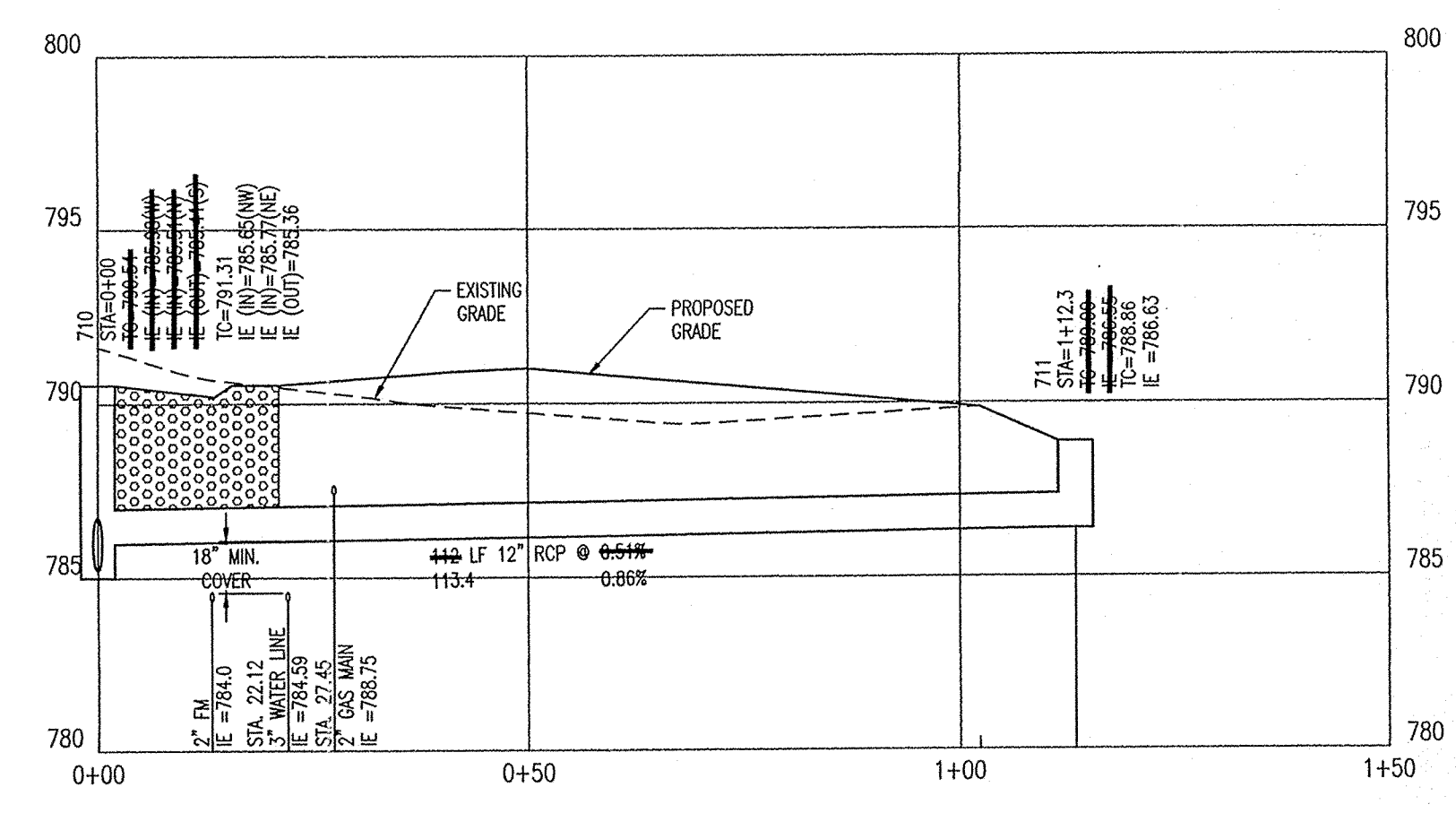
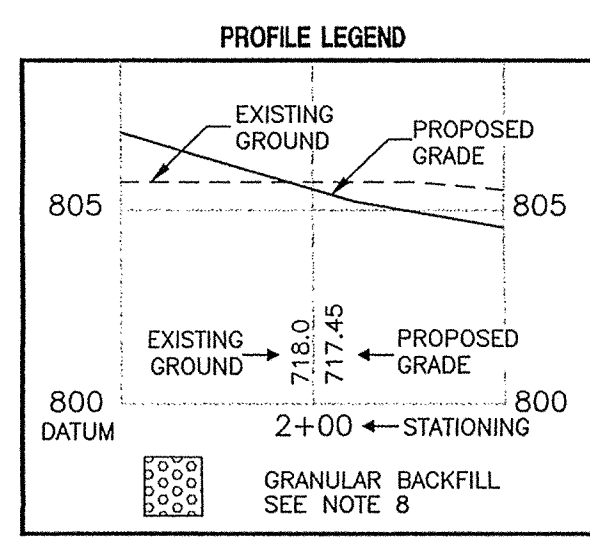

PROFILE STRUCTURE 710 TO 711
HORIZONTAL SCALE: 1"=20'
VERTICAL SCALE: 1"=5'

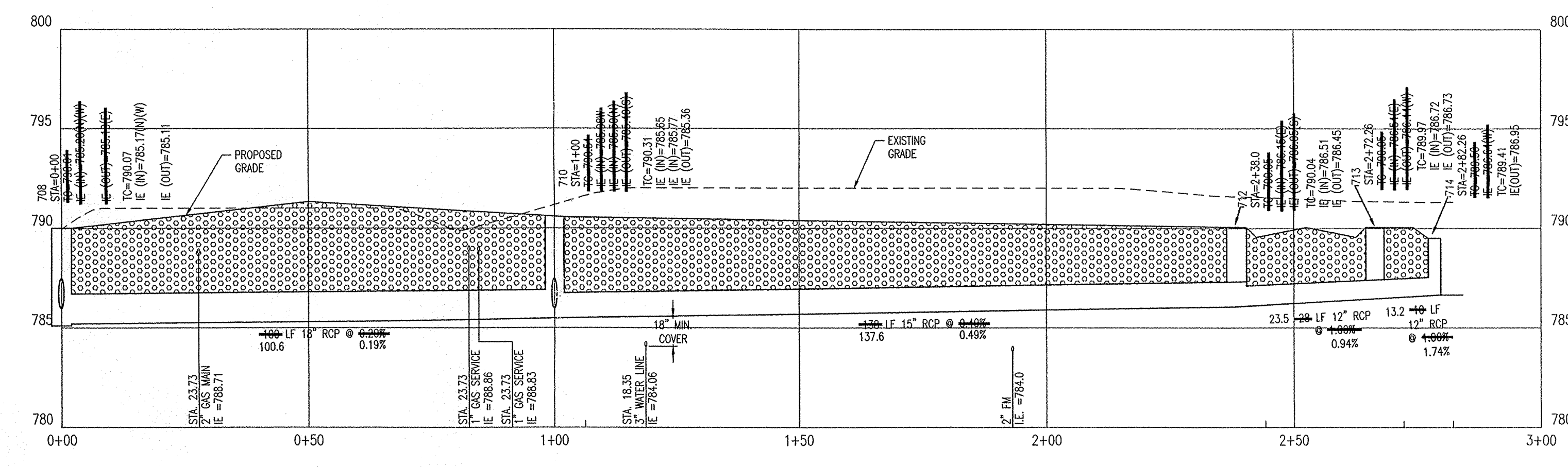

PROFILE STRUCTURE 708 TO 714
HORIZONTAL SCALE: 1"=20'
VERTICAL SCALE: 1"=5'

This information was gathered for input into the County Geographical Information System and is considered an official record of the GIS.
Entry Date: 5-4-06
Entered by: Suzanne Mills

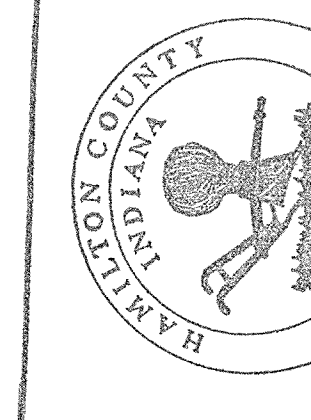

AS BUILT
date: 8/24/04
RECORD DRAWING

"HOLEY MOLEY" SAYS CALL AT LEAST TWO FULL WORKING DAYS BEFORE YOU DIG... IT'S THE LAW.
CAUTION: LOCATIONS OF ALL EXISTING UNDERGROUND UTILITIES SHOWN ON THIS PLAN ARE BASED UPON ABOVE GROUND EVIDENCE (INCLUDING, BUT NOT LIMITED TO, MANHOLES, INLETS, VALVES, AND MARKS MADE UPON THE GROUND BY OTHERS) AND ARE SPECULATIVE IN NATURE. THERE MAY ALSO BE OTHER EXISTING UNDERGROUND UTILITIES FOR WHICH THERE IS NO ABOVE GROUND EVIDENCE OR FOR WHICH NO ABOVE GROUND EVIDENCE WAS OBSERVED. THE EXACT LOCATIONS OF SAID EXISTING UNDERGROUND UTILITIES SHOULD BE VERIFIED BY THE CONTRACTOR PRIOR TO ANY AND ALL CONSTRUCTION.

1-800-382-5544
CALL TOLL FREE
1-800-428-5200
FOR CALLS OUTSIDE OF INDIANA

ARCHITECTURE
CIVIL ENGINEERS
LANDSCAPE ARCHITECTURE
LAND SURVEYORS
TRANSPORTATION ENGINEERS
GIS

7172 GRAHAM ROAD
INDIANAPOLIS, INDIANA 46250
(317) 842-6777 FAX (317) 841-4798
E-Mail: crpe@crpe.biz

CRPE

STORM PLAN AND PROFILES
MARINA VILLAGE
The Marina Limited Partnership
11691 Fall Creek Road
Indianapolis, IN 46256

PHONE: (317) 845-0720
FAX: (317) 845-0788

CERTIFIED BY:
JOSEPH A. SHARP
REGISTERED PROFESSIONAL ENGINEER
No. 15179
STATE OF INDIANA

Drawn By:
ASBUILTS DRAWN BY: CMQ 8/18/04
Checked By:

Quality Assurance:

Scale: 1"=20'

Sheet: **C702**

Date: 08-04-03
Project Number: 030366-20000

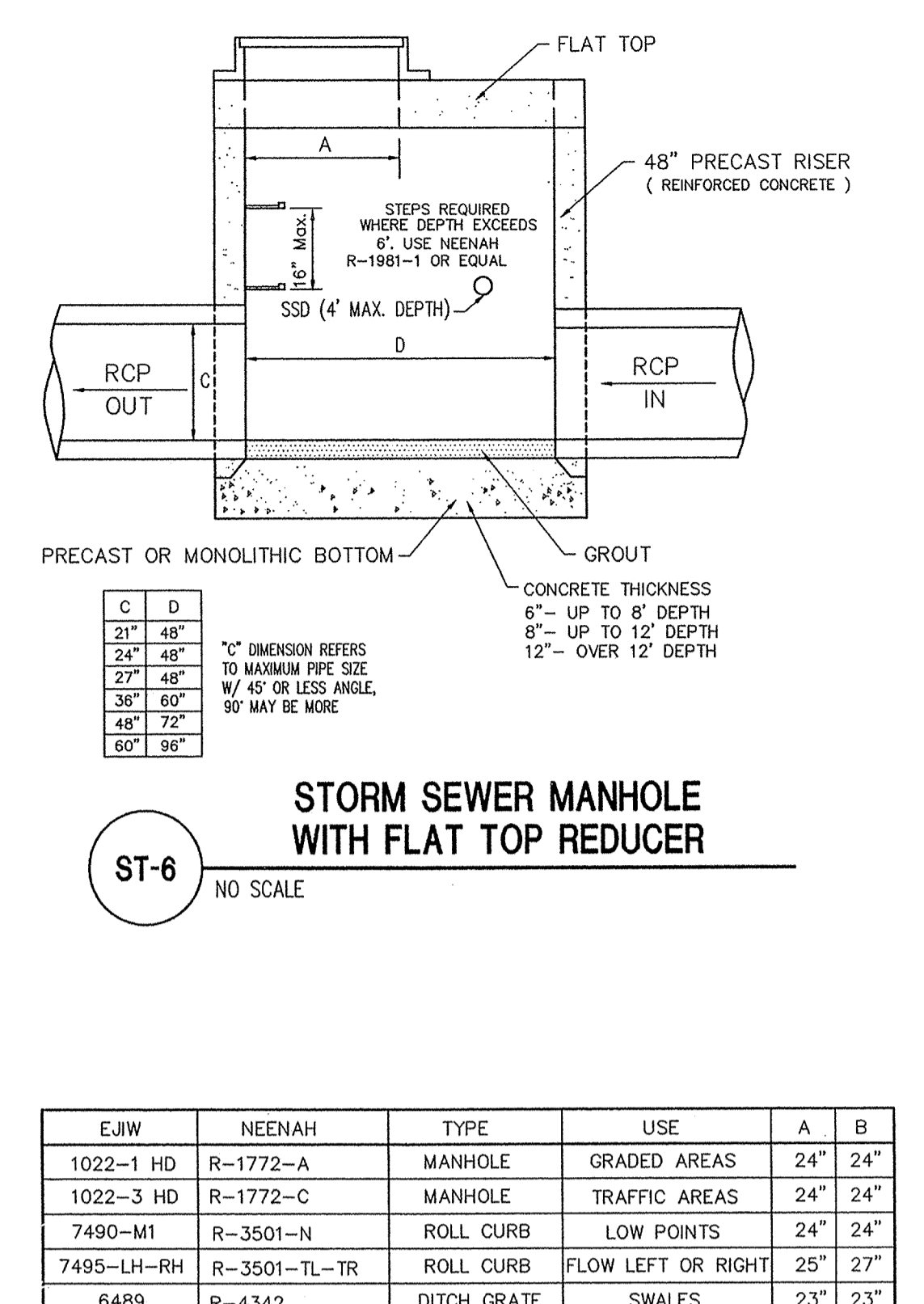
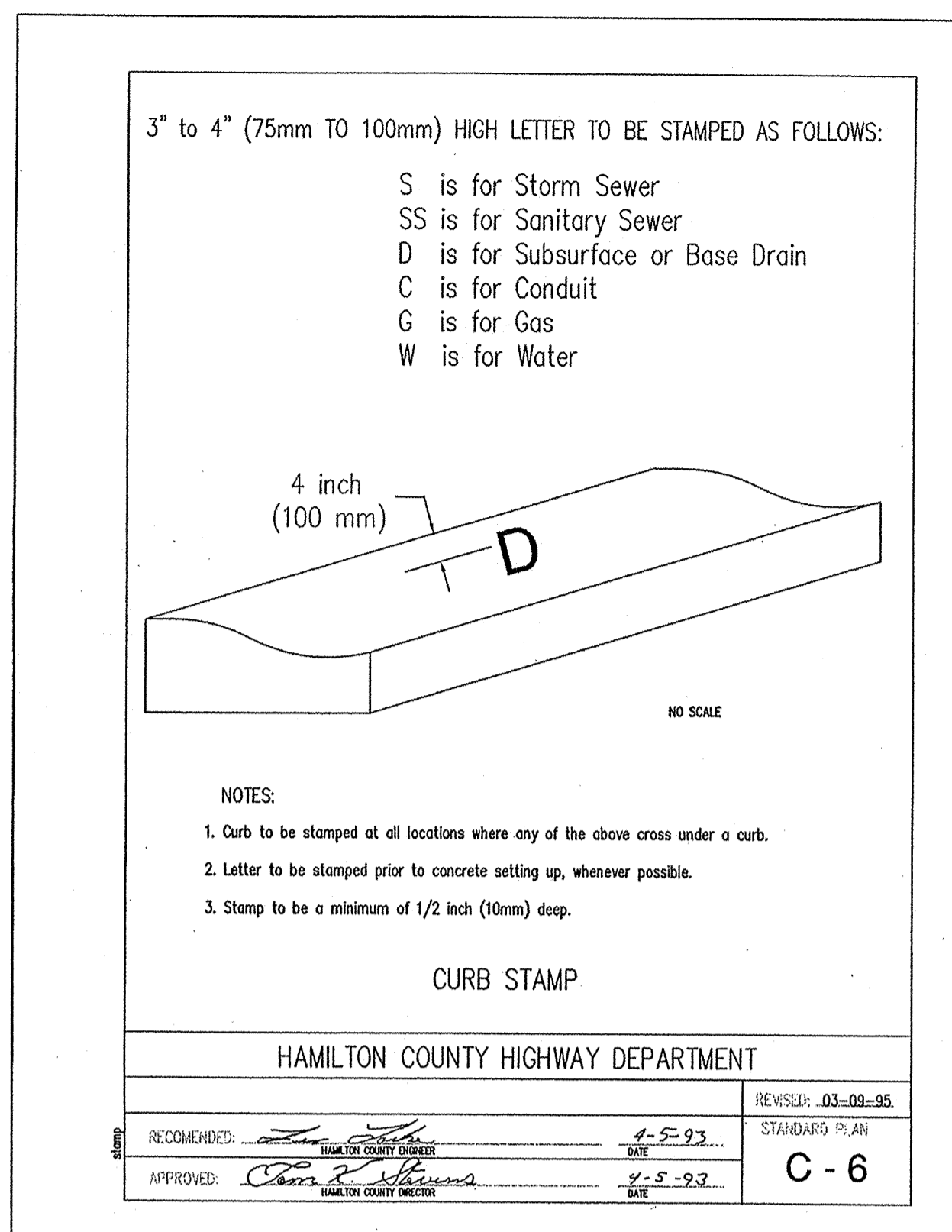
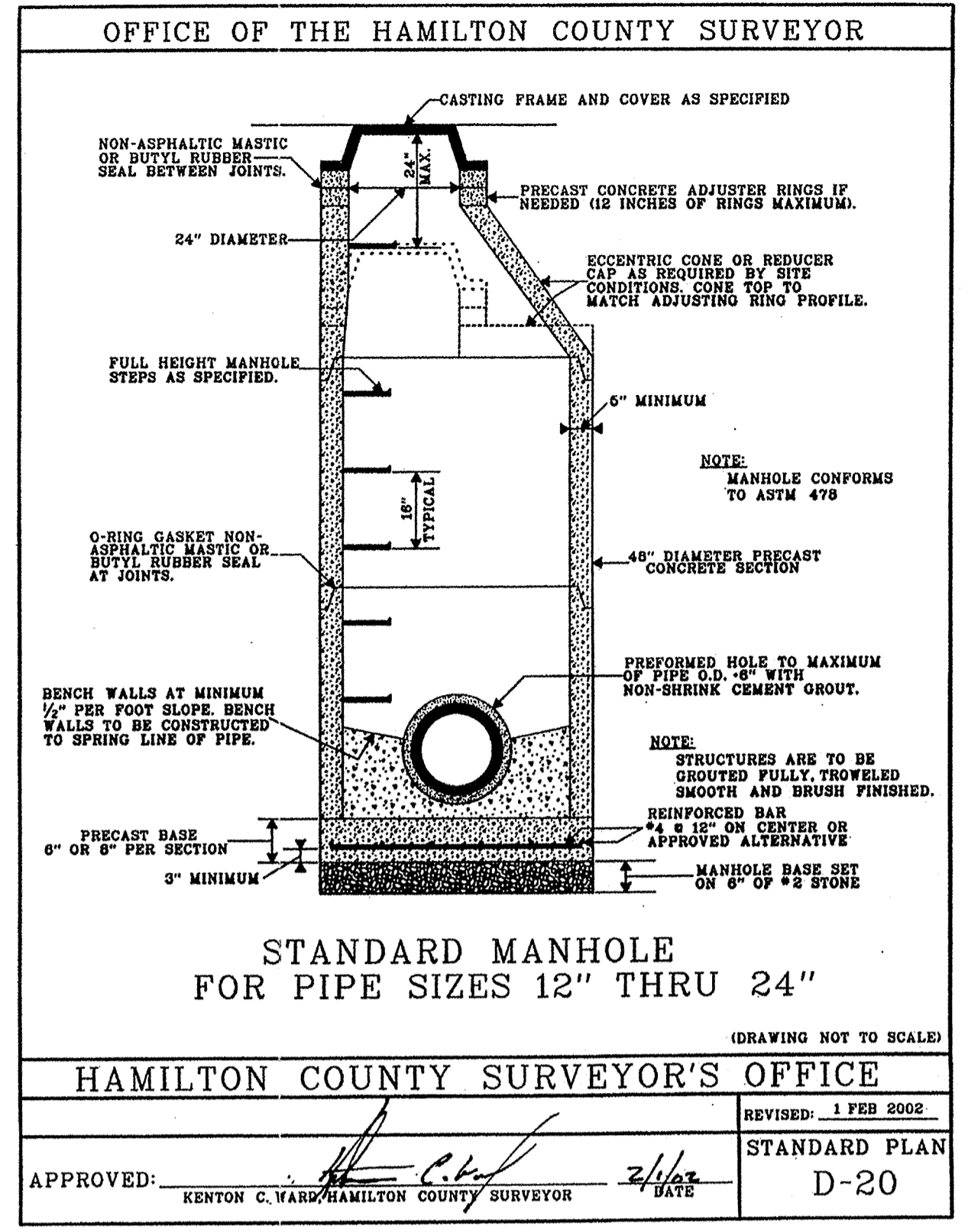

STORM STRUCTURE DATA TABLE

STR. NUMBER	CASTING*	DETAIL NO.	TOP OF CASTING
701	END SECTION	ST-3A	785.01
702	R-3501-N	ST-23	780.01
703	R-3501-N	ST-23	780.01
704	END SECTION	ST-3A	785.01
705	R-3501-N	ST-23	780.01
706	R-3501-N	ST-23	780.01
707	END SECTION	ST-3A	785.00
708	R-3501-N	ST-6	791.01
709	R-3501-N	ST-23	780.01
710	R-1772-C	ST-6	780.04
711	R-4342	ST-23	780.00
712	R-3501-N	ST-23	780.01
713	R-3501-N	ST-23	780.01
714	R-4342	ST-23	789.51

*CASTING TO BE NEENAH OR EQUAL PER HAMILTON COUNTY STANDARD DETAILS.

Hamilton County, Indiana logo.

Entry Date: 5-4-06
 Entered by: SLM

